

# Call for Sculpture

## Speaking within Space



Presented in the Harlan Art Gallery of **Seton Hill University**, just one block from the Performing Arts Center in downtown Greensburg's historic arts corridor.

**Open to all artists working within the PA/OH/WV Tri-State Region.**

*Up to three (3) submissions per artist.*

### **Location:**

---

Harlan Art Gallery  
Seton Hill University Arts Center  
205 West Otterman Street, Greensburg, Pa. 15601

**Exhibition Dates: March 19 to April 10, 2020**

**SUBMISSION DUE: Sunday, March 1, 2020, midnight**

*Selection Notification by Monday, March 9*

### **Juror: Todd Keyser, Gallery Director, Seton Hill University**

Todd Keyser is an abstract painter, independent curator, adjunct professor, and arts writer. Formerly the Assistant Director of Gross McCleaf Gallery in Philadelphia, he now teaches Exploring Drawing for non-majors at Seton Hill University. His writings on art and aesthetics can be found at Title Magazine, Bmoreart.com, Criticaleyes.org and Pittsburgharticulate. Keyser's work has been included in a number of group exhibitions such as the AAP Annual Exhibition at the Carnegie Museum of Art, curated by Sarah Lehrer-Graiwer and at Pittsburgh Filmmakers, curated by Adam Welsh. Keyser's work was featured in a two-person show with David Kettner at Gross McCleaf Gallery in February 2015 and solo exhibition in May 2017. He received his MFA from the Maryland Institute College of Art (MICA), his BFA from the University of the Arts, and completed the traditional painting and drawing program at the Pennsylvania Academy of the Fine Arts.

### **Exhibition Schedule:**

Submission: Sunday, March 1, midnight  
Selection: Notification by March 9  
Drop-off: Sunday, March 15, 1:00 – 4:00pm  
Installation: Monday - Wednesday, March 16 - 18  
Pick-up: Saturday, April 11, 1:00 – 4:00pm  
Reception: Thursday, March 19, 4:00 – 8:00pm

**Fee:** SOS Members – FREE – Please renew your 2020 Membership!

Non-Members - To submit to this exhibition, please register to become a member of SOS (\$40) by visiting <http://www.societyofsculptors.org/join-sos.html>

**Membership** entitles all artists to participate in organization events and member-only exhibitions, representation on our website, plus 10% discount on all purchases at Artist and Craftsman Supply.

**Shipping and Delivery:**

All accepted artists are required to deliver or ship their work to the Harlan Gallery, Seton Hill Arts Center, 205 W. Otterman St., Greensburg, PA, 15601.

**Artwork Criteria:**

All types of sculpture are acceptable; pedestal pieces, floor and wall artwork, plus installations. *Seton Hill Univ. reserves the right to remove artwork that is considered unstable or otherwise hazardous to the viewing public.*

**Gallery Specifications and Pedestal Information:**

All artwork must fit through a double door opening. Steel Beams exposed for hanging from ceiling (12-14'). Pedestals available.

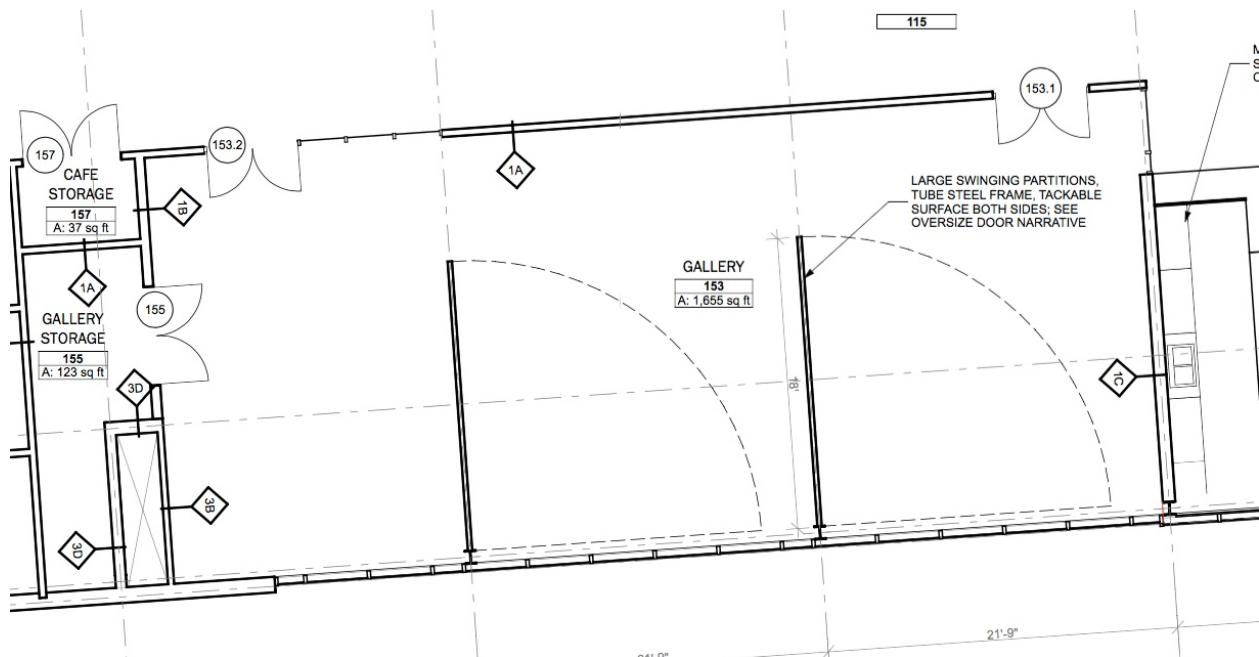

## **Sales:**

---

Seton Hill University will supply interested patrons with artist contact information. All transactions for artwork will be made by the artist, who will be responsible for delivery, taxes, etc.

## **Insurance:**

---

All work is insured for the duration of the exhibition. Artist is responsible for artwork during delivery, pick-up, and/or shipping.

## **Questions:**

Contact Todd Keyser, [tkeyser@setonhill.edu](mailto:tkeyser@setonhill.edu), or the Visual and Performing Arts School office, Alyssa Wells, 724-552-2900

## **Selection:**

Up to three (3) submissions per artist

All works will be juried from a PDF file. *Example of submission format attached below.*

## **To Submit:**

You must be a new or current member of SOS.

To become a member visit: <http://www.societyofsculptors.org/join-sos.html>

Click on the New Membership or Existing Membership Renewal tab (\$40).

**Create a one-page PDF file for each artwork you wish to submit.**

**PLEASE** follow the formatted example shown below.

*All PDF documents will be assembled into one document with no names visible to the juror.*

**Send your PDF documents as attachments to Duncan MacDiarmid at:**

[macd@earthviewstudios.com](mailto:macd@earthviewstudios.com)

**Subject Line: *Submission - Speaking Within Space***

You will receive a submission confirmation email.

## **PDF Format:**

Name each PDF document with: **Your Name\_Title of Work**

**Example: Jane Smith\_Tiger on the Mountain**

Paste image(s) of your sculpture within this document.

Use one or more images, as needed, to convey the spirit of the sculpture.

At bottom of page list:

*FONT SIZE - 14*

Title

Material

Dimensions

Sale price or NFS

If you wish, you may add a brief description of your sculpture, 1-3 sentences.

Do not include your name within this page!

Sample PDF Document Name: Henry Moore\_King and Queen

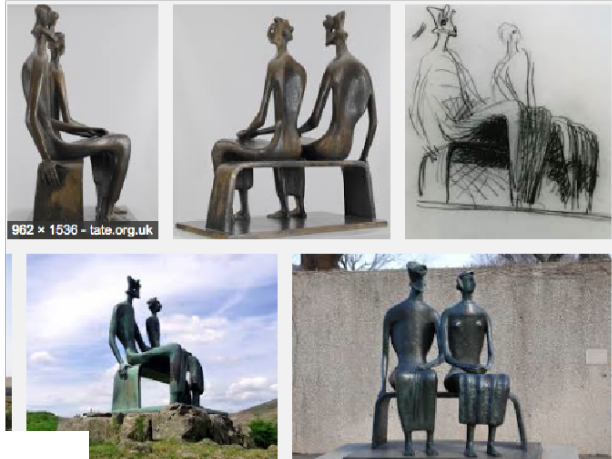

Exterior  
King and Queen  
Bronze  
1640 x 1390 x 910 mm  
NFS

Envisioned as a married couple of high social stature, this sculpture strives to bring these individuals "down to earth". Sitting on a common bench these figures could represent any two people sharing a position in life.