



Call for Artwork and Proposals

MACRO / MICRO

Immersive Environments & Intimate Creations

How does a large art installation become physically and physiologically immersive? In contrast, what triggers a similar experience from a smaller work of sculpture? This exhibition asks artists to create work utilizing any of the following: material, space, time, technology, and personal interaction to present visitors with engaging concepts that consider any of our multi-sensory environments, be it personal, natural, global, virtual, or other.

Location:

RMU Media Arts Gallery

Robert Morris University
Wheatley Center
6001 University Blvd.,
Moon Township, PA 15108
(800) 762-0097

<https://www.rmu.edu/academics/schools/sihss/arts-humanities/media-arts-gallery>

See last page for directions.

Gallery Hours

Monday & Friday: 10am-6pm

Tuesday & Thursday: 12-6pm

Wednesday: 10am-2pm

Exhibition Dates: August 21 - September 29, 2023

Site Visit with Gallery Director:

Visit the gallery to discuss and generate ideas with the gallery director.

Tuesday, May 9, 2023

Time: 5-6pm

Stop in to view the space anytime during regular gallery hours (listed above) between April 19th and May 5th. After May 5th Gallery hours will be by appointment only for the summer.

Submission Due: Sunday, June 18, 2023, midnight

Selection Notification by July 2nd

Selection/Jurors:

RMU Gallery Directors, Andrew Ames and Christine Holtz will be the jurors for this exhibition.

Exhibition Schedule:

- Submission: Sunday, June 18, 2023, midnight
- Selection: Notification by July 2nd
- Installation: Wednesday - Sunday, August 16 – 20 (by appointment)
- Reception: Friday, September 1st, 5 – 8pm
- Deinstallation: September 30 – October 1

Fee:

This exhibition is free to enter for all new and current members.

Apply for SOS Membership:

Sign-up here to access all benefits plus other sponsored exhibitions:

<https://www.societyofsculptors.org/membership.html>

Artwork Criteria:

Each artist may submit up to three artworks.

All types of sculpture are acceptable.

Inventive use of the space is encouraged, but not required.

Use of media technology is encouraged, but not required.

RMU Media Arts Gallery reserves the right to remove artwork that is considered unstable or otherwise hazardous to the viewing public.

Sales:

The Society of Sculptors will supply interested patrons with artist contact information.

All transactions for artwork will be made by the artist, who will be responsible for delivery, taxes, etc.

Pick-up:

All artwork must be picked-up on the dates specified unless other arrangements have been made.

Any artwork remaining at the close of the exhibition will be considered abandoned and to be handled by RMU Media Arts Gallery as they choose.

Insurance and Liability:

RMU Gallery has limited liability coverage that will cover some aspects of the artwork while on display.

To Submit:

Please create a one or multi-page PDF file for each artwork/proposal you wish to submit.

Title each document with your name and title of artwork/proposal.

Send to: societyofsculptors.pittsburgh@gmail.com

Questions? Contact Sarah Simmons at: sarahsimmonsart@gmail.com

Amy Short at: amyshortart@gmail.com

Duncan MacDiarmid at: macd@earthviewstudios.com

Gallery Specifications:

FLOOR PLAN & GALLERY DIMENSIONS

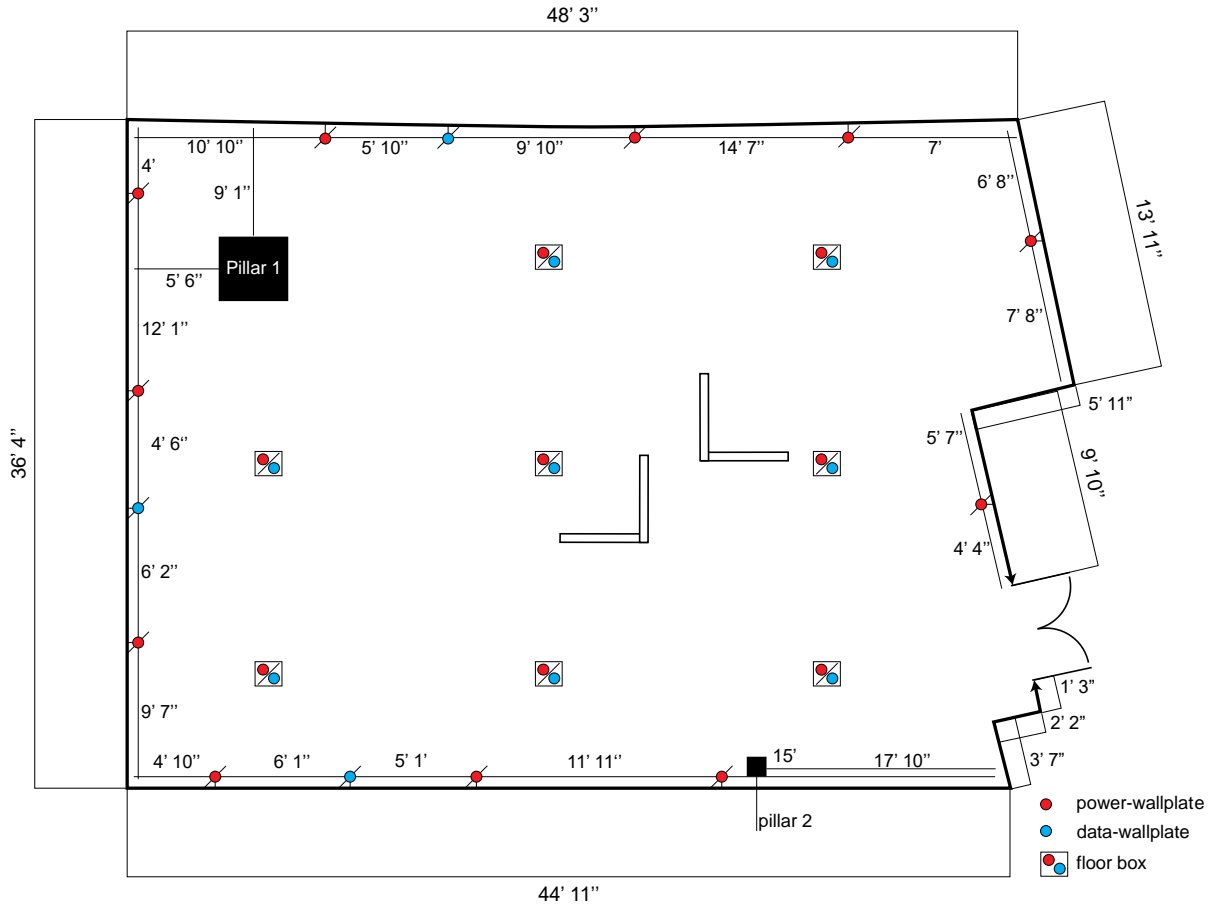

pillar 1: 2' 2" x 2' 1"
pillar 2: 5' x 5'



Directions:

Guests must stop at the [Barry Center police station](#) to obtain a visitor parking permit. Guests will be required to hang a guest parking permit from their rear view mirror in order to be eligible to park on campus in the reserved, general, faculty/staff or registered free parking areas. To get to the Barry Center, turn right at the second stop sign after entering campus. The Barry Center is the first building on your left.

From the University Boulevard main RMU entrance, turn left at the third stop sign, the Wheatley Center is the large building on your right.

